

# UV-XVR-104G3

Video recorder 5n1

Uniarch

4 CH HDTVI / HDCVI / AHD / CVBS

+ 2 extra IP

Audio

Supports 1 hard disk



Uniarch

DVR 5n1

4 BNC video CH (IP-replaceable)

AHD, TVI, CVI, CVBS, CVBS

48 Mbps bandwidth supported

Maximum IP resolution 4 Mpx

Maximum analog resolution 5 Mpx

Audio

HDMI and VGA output

RS485

2 x USB 2.0

Mouse

Space for 1 HDD up to 8 TB

WEB, CMS, Smartphone and NVR interface

ONVIF Compatible

# Specifications

Brand	Uniarch
Video format	HDTVI / HDCVI / AHD / CVBS / IP
Video inputs	4CH BNC
Hybrid configuration	Up to 6 IP Channels (4Mpx) replacing all the BNC channels
Video outputs	1 HDMI Full HD, 1 VGA
Audio inputs	1 Channel RCA
Audio outputs	1 Channel RCA
Bidirectional audio	Reusing the audio input/output
Display resolution	1920x1080@60Hz, 1920x1080@50Hz, 1600x1200@60Hz, 1280x1024@60Hz, 1280x720@60Hz, 1024x768@60Hz
Maximum IP recording resolution	4 Mpx
Analog cameras supported	TVI / AHD: 5MP@20fps, 4MP@30fps, 1080P@30fps, 720P@60fps
	CVI: 5MP@20fps, 4MP@30fps, 1080P@30fps, 720P@30fps
Main Stream recording encoding	5MPLite@12fps; 4MPLite@15fps; 1080P@15FPS; 720P@25FPS
Extra Stream recording encoding	D1@12FPS; D1@15FPS; D1@25FPS
Recording method	Manual, programmed, motion detection
Internal memory	1 HDD SATA 3.5" of up to 8TB (not included)
External interface	2 x USB (Mouse and backup) / RJ45 10M/100M/1000M (Ethernet) / RS485
Remote access	Web Browser, CMS Software (EZStation), Smartphone (EZView/EZLive)
Power	DC 12V / 8W
Dimensions / Weight	260mm x 218mm x 47mm / 1.1 kg

# DH-HAC-HDW1200TRQ(-A)

2MP HDCVI Quick-to-install IR Eyeball Camera



- Max 30fps@1080P
- Quick-to-install eyeball saves installation time
- Built-in mic (-A)
- CVI/CVBS/AHD/TVI switchable
- 3.6mm fixed lens (2.8mm optional)
- Max. IR length 25m, Smart IR
- IP50, DC12V



## System Overview

Experience 1080P full HD video and the simplicity of using existing cabling infrastructure with HDCVI. The Lite series 1080P HDCVI camera features a compact design and offers a high quality image at a friendly price. It offers various motorized/fixed lens models with a multi-language OSD and HD/SD switchable output. Its structural flexibility and high cost-performance makes the camera an ideal choice for SMB solutions.

## Functions

### 4 Signals over 1 Coaxial Cable

HDCVI technology supports 4 signals to be transmitted over 1 coaxial cable simultaneously, i.e. video, audio\*, data and power. Dual-way data transmission allows the HDCVI camera to interact with the XVR, such as sending control signal or triggering alarm. Moreover, HDCVI technology supports PoC for construction flexibility.

\* Audio input is available for some models of HDCVI cameras.

### Easy Installation

HDCVI Quick-to-install eyeball adopts quick-to-install pedestal, which can achieve easier installation than conventional eyeball. Quick-to-install camera reduces time and labor costs.

### Long Distance Transmission

HDCVI technology guarantees real-time transmission at long distance without any loss. It supports up to 800m(1080p)/1200m(720P) transmission via coaxial cable, and up to 300m(1080P)/450m(720P) via UTP cable.\*

\*This function is available for select models.

### Simplicity

HDCVI technology inherits the feature of simplicity from traditional analog surveillance system, making itself a best choice for investment protection. HDCVI system can seamlessly upgrade the traditional analog system without replacing existing coaxial cabling. The plug and play approach enables full HD video surveillance without the hassle of configuring a network.

## Smart IR

The camera is designed with IR LED illumination for best lowlight performance. Smart IR is a technology that ensures ensure brightness uniformity in B/W image under low illumination. Dahua's unique Smart IR adjusts to the intensity of camera's infrared LEDs to compensate for the distance of an object, and prevents IR LEDs from overexposing images as the object come closer to the camera.

## Multi-formats

The camera supports multiple video formats including HDCVI, CVBS and other two common HD analog formats in the market. The four formats can be switched over through OSD menu or by PFM820 (UTC controller). This feature makes the camera to be compatible with most end users' existing HD/SD DVRs.

## Multi-language OSD

OSD menu provides multiple image adjustments and function settings to meet the requirements of different monitoring scenes. The OSD menu includes configurations such as backlight mode, day/night, white balance, privacy mask and motion detect. The camera supports 11 languages for OSD menu, namely, Chinese, English, French, German, Spanish, Portuguese, Italian, Japanese, Korean, Russian and Polish.

## Protection

With working temperature range of -40°C to +50°C (-40°F to 122°F), the camera is designed for extreme temperature environments. Supporting ±30% input voltage tolerance, this camera suits even the most unstable power supply conditions. Its 4KV lightning rating provides protection against the camera and its structure from the effects of lightning.

Technical Specification						Noise Reduction		2D NR	
Camera						Smart IR		Yes	
Image Sensor		1/2.7 inch CMOS				Mirror		Off/On	
Max. Resolution		1920(H)×1080(V)				Privacy Masking		Off/On (8 area, rectangle)	
Pixel		2MP				Certifications			
Scanning System		Progressive				Certifications			
Electronic Shutter Speed		PAL: 1/25s–1/100000s NTSC: 1/30s–1/100000s				CE (EN55032:2015, EN 61000-3-2:2014, EN 61000-3-3:2013, EN55024:2010+A1:2015, EN 55035:2017, EN50130-4:2011+A1:2014) FCC (CFR 47 FCC Part 15 subpartB, ANSI C63.4-2014) UL (UL60950-1+CAN/CSA C22.2 No.60950-1)			
S/N Ratio		>65dB				Port			
Min. Illumination		0.02 Lux/F1.9, 30IRE, 0 Lux IR on				Video Output			
Illumination Distance		25 m (82.0 ft)				Video output choices of CVI/TVI/AHD/CVBS by one BNC port			
Illuminator On/Off Control		Auto; manual				Audio Interface			
Illuminator Number		2 (IR)				Built-in Mic (-A)			
Pan/Tilt/Rotation Range		Pan: 0°–360° Tilt: 0°–78° Rotation: 0°–360°				Power			
						Power Supply			
						12V ±30% DC			
						Power Consumption			
						Max 2.6 W (12V DC, IR on)			
Lens						Environment			
Lens Type		Fixed-focal				Operating Temperature			
Mount Type		M12				-40°C to +50°C (-40°F to 122°F);<95% (non-condensation)			
Focal Length		2.8 mm; 3.6 mm				Storage Temperature			
						-40°C to +50°C (-40°F to 122°F);<95% (non-condensation)			
Max. Aperture		2.8 mm: F1.9 3.6 mm: F2.0				Protection Grade			
						IP50			
Field of View		2.8 mm: H: 101°; V: 54° ; D: 119° 3.6 mm: H: 84°; V: 45°; D: 100°				Structure			
Iris Type		Fixed iris				Casing			
						Plastic			
Close Focus Distance		2.8 mm: 0.5 m (1.64 ft) 3.6 mm: 0.8 m (2.62 ft)				Dimensions			
						Φ97.1 mm × 93.0 mm (Φ3.82" × 3.66")			
DORI Distance	Lens	Detect	Observe	Recognize	Identify	Net Weight			
	2.8 mm	38.6 m (126.6 ft)	15.4 m (50.5 ft)	7.7 m (25.3 ft)	3.9 m (12.8 ft)	0.17 Kg (0.37lb)			
	3.6 mm	49.7 m (163.1 ft)	19.9 m (65.3 ft)	9.9 m (32.5 ft)	5 m (16.4 ft)	Gross Weight			
						0.23 Kg (0.51lb)			
Video									
Frame Rate		CVI: 1080P@25/30fps; 720P@25/30fps; 720P@50/60fps; AHD: 1080P@25/30fps; 720P@25/30fps; TVI: 1080P@25/30fps; 720P@25/30fps; 720P@50/60fps; CVBS: 960H							
Resolution		1080P (1920×1080); 720P (1280×720); 960H (960×576/960×480)							
Day/Night		Auto switch by ICR							
BLC		BLC/HLC/DWDR							
WDR		DWDR							
White Balance		Auto; manual							
Gain Control		Auto; manual							

## Ordering Information

Type	Part Number	Description
2MP Camera	DH-HAC-HDW1200TRQP 2.8 mm	2MP HDCVI IR Eyeball Camera, PAL
	DH-HAC-HDW1200TRQP 3.6 mm	
	DH-HAC-HDW1200TRQN 2.8 mm	2MP HDCVI IR Eyeball Camera, NTSC
	DH-HAC-HDW1200TRQN 3.6 mm	
	DH-HAC-HDW1200TRQP-A 2.8 mm	2MP HDCVI IR Eyeball Camera, PAL
	DH-HAC-HDW1200TRQP-A 3.6mm	
	DH-HAC-HDW1200TRQN-A 2.8mm	2MP HDCVI IR Eyeball Camera, NTSC
	DH-HAC-HDW1200TRQN-A 3.6mm	
Accessories	PFA13G	Junction Box
	PFB205W	Wall Mount Bracket
	PFA152-E	Pole Mount Bracket (For use with PFB205W)
	PFA130-E	Junction box
	PFM800-E	Passive HDCVI Balun
	PFM321D	12V 1A Power Adapter
	PFM820	UTC Controller
	PFM904	Integrated Mount Tester

## Accessories

### Optional:



PFA13G  
Junction Box



PFB205W  
Wall Mount Bracket



PFA152-E  
Pole Mount Bracket  
(For use with PFB205W)



PFA130-E  
Junction box



PFM800-E  
Passive HDCVI Balun



PFM321D  
12V 1A Power Adapter



PFM820  
UTC Controller



PFM904  
Integrated Mount Tester

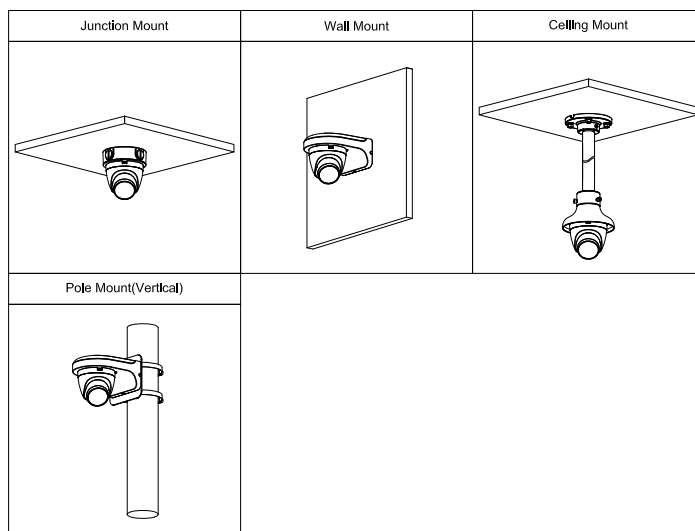

## Dimensions (mm[inch])

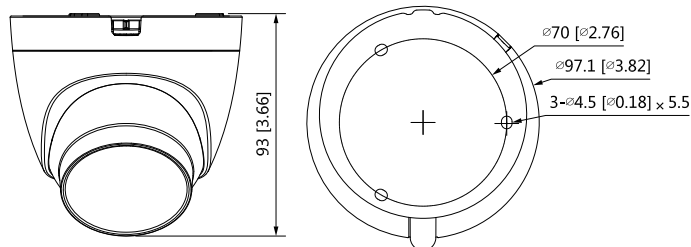

# DH-HAC-HFW1500TLM-IL-A

5MP Smart Dual Light HDCVI Fixed-focal Bullet Camera



\* The parameters and datasheets below can only be applied to 1500-IL series.

\* In order to use the 5MP 16:9 and the Smart Dual Light HDCVI camera, the firmware of XVR must be upgraded to V4.001.0000004.1.R.220323 or later version.

- Max 25 fps@5MP (16:9 video output).
- Smart Dual Light.
- 40 m illumination distance.
- Super Adapt.
- Built-in MIC.
- 3.6 mm fixed lens (2.8 mm optional).
- CVI/CVBS/AHD/TVI switchable.
- IP67, 12 VDC.

## System Overview

The Lite Series is a great choice for consumers looking for high quality monitoring products at a reasonable price. Its low cost and high performance make it ideal for residential areas and SMB solutions. This series is equipped with a wide range of technologies, such as full-color and starlight, providing various solutions for different scenarios.

## Functions

### Broadcast-quality Audio

Audio signal transmission over coaxial cables is supported by the HDCVI camera. It adopts a unique audio processing and transmission technology that restores source audio and eliminates noise, ensuring the quality and reliability of the audio information that is collected. This becomes important for video surveillance applications that use audio information as a type of supplementary evidence.

### Smart Dual Light

With its smart dual light mechanism, the camera automatically turns on the white light when Perimeter Protection/SMD Plus function of AI XVR detects a target in the rule area to capture clear, vivid images. When the target leaves the rule area, the camera automatically switches over from the white light to the IR light to significantly reduce light pollution.

### Super Adapt

With its intelligent algorithm, the camera automatically adjusts its parameters to provide optimal performance and vivid images.

### Protection (IP67, Wide Voltage)

IP67: The camera passed a series of rigorous dust and immersion tests. Its enclosure is both dust-proof and waterproof, and can function normally while being immersed in 1 m deep water for up to 30 minutes. Wide voltage: The camera has  $\pm 30\%$  input voltage tolerance (for some power supplies) and a wide voltage range, making it suitable for a variety of outdoor scenarios.



### 4 Signals over 1 Coaxial Cable

HDCVI technology supports 4 signals (video, audio\*, data and power) which are simultaneously transmitted over a coaxial cable. Dual-way data transmission allows the HDCVI camera to interact with the XVR to perform various actions such as sending control signals and triggering alarms. HDCVI technology also supports PoC, which makes the camera easy and quick to install.

\* Audio input is available for select HDCVI camera models.

### Long Distance Transmission

HDCVI technology provides long distance transmission in real time without transmission loss. It supports transmission distances up to 700 m for 2-MP/5-MP/8-MP HD videos through coaxial cables, and up to 300 m through UTP cables. The results were obtained and verified through rigorous testing in Dahua's test laboratory.

### Simplicity

HDCVI technology inherits the simplicity of traditional analog surveillance systems, making it a great mechanism for protecting your valuables. HDCVI can be upgraded from the traditional analog system without replacing the existing coaxial cabling. Its plug and play design enables it to produce high-definition videos during surveillance without the hassle of configuring a network.

### Multi-language OSD

The OSD offers multiple functions to meet the many requirements of a monitoring scene, such as backlight mode, day/night mode, white balance, privacy mask, and motion detection. 11 languages are available for OSD: Chinese, English, French, German, Spanish, Portuguese, Italian, Japanese, Korean, Russian and Polish.

Technical Specification						Gain Control		Auto/Manual	
Camera						Noise Reduction		2D NR	
Image Sensor		5 MP CMOS				Illumination Mode		Smart IR&WL; WL Mode; IR Mode	
Max. Resolution		2880 (H) × 1620 (V)				Mirror		Yes	
Scanning System		Progressive				Privacy Masking		Off/On (8 areas, rectangle)	
Electronic Shutter Speed		PAL: 1/25 s–1/100000 s NTSC: 1/30 s–1/100000 s				Certification			
Min. Illumination		0.05 lux@F1.6 (Color, 30 IRE) 0.005 lux@F1.6 (B/W, 30 IRE) 0 lux (Illuminator on)				Certifications			
S/N Ratio		>65 dB				CE-LVD: EN 62368-1; CE-EMC: EN 55032; EN 55035; FCC: 47 CFR FCC Part 15, Subpart B; UL: UL62368-1 + CAN/CSA C22.2 No. 62368-1-14			
Illumination Distance		IR: 40 m (131.23 ft) Warm Light: 40 m (131.23 ft)				Port			
Illuminator On/Off Control		Auto/Manual				Video Output			
Illuminator Number		2 (Warm light);2 (IR light)				Video output choices of CVI/TVI/AHD/CVBS by one BNC port			
Angle Adjustment		Pan: 0°–360° Tilt: 0°–90° Rotation: 0°–360°				Audio Input			
						One channel built-in mic			
						Power			
Power Supply		12 VDC ± 30%							
Power Consumption		Max 4.5 W (12 VDC, WLED on)							
Environment									
Operating Temperature		–40 °C to +60 °C (–40 °F to +140 °F)							
Operating Humidity		<95% (RH), non-condensing							
Storage Temperature		–40 °C to +60 °C (–40 °F to +140 °F)							
Storage Humidity		<95% (RH), non-condensing							
Protection		IP67							
Structure									
Casing Material		Metal front cover + plastic rear barrel + metal bracket							
Product Dimensions		198.4 mm × 80.2 mm × 76.2 mm (7.81" × 3.16" × 3")							
Net Weight		0.3 kg (0.66 lb)							
Gross Weight		0.42 kg (0.93 lb)							
Installation		Wall mount; ceiling mount; vertical pole mount							
Video									
Video Frame Rate		CVI: PAL: 5M@25 fps; 4M@25 fps; 1080p@25 fps; NTSC: 5M@25 fps; 4M@30 fps; 1080p@30 fps AHD: PAL: 4M@25 fps; NTSC: 4M@30 fps TVI: PAL: 4M@25 fps; NTSC: 4M@30 fps CVBS: PAL: 960H; NTSC: 960H							
Resolution		5M (2880 × 1620); 4M (2560 × 1440); 1080p (1920 × 1080); 960H (960 × 576/960 × 480)							
Day/Night		Auto(ICR)/Color/B/W							
BLC		BLC; HLC; DWDR							
WDR		DWDR							
White Balance		Auto; Area white balance							

Ordering Information		
Type	Model	Description
5M Camera	DH-HAC-HFW1500TLM-IL-A	5MP Smart Dual Light HDCVI Fixed-focal Bullet Camera, PAL
	DH-HAC-HFW1500TLMN-IL-A	5MP Smart Dual Light HDCVI Fixed-focal Bullet Camera, NTSC
Accessories (Optional)	PFA134	Junction Box
	PFA130-E	Water-proof Junction Box
	PFA152-E	Pole Mount Bracket
	PFM800-4K	1-CH Passive Video Balun
	PFM321D	12V 1A Power Adapter
	PFM904	Integrated Mount Tester

Accessories

Optional:



PFA134  
Junction  
Box



PFA130-E  
Water-proof  
Junction Box



PFA152-E  
Pole Mount  
Bracket



PFM800-4K  
1 Channel Passive  
HDCVI Balun



PFM321D  
12V 1A Power  
Adapter



PFM904  
Integrated Mount  
Tester

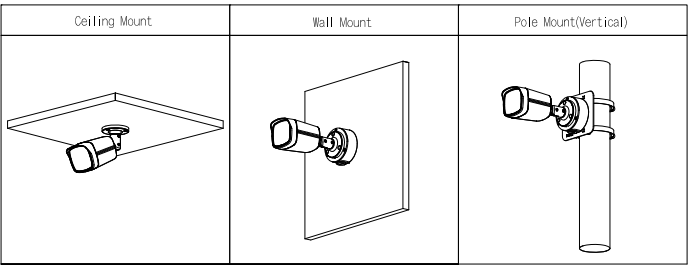

Dimensions (mm [inch])

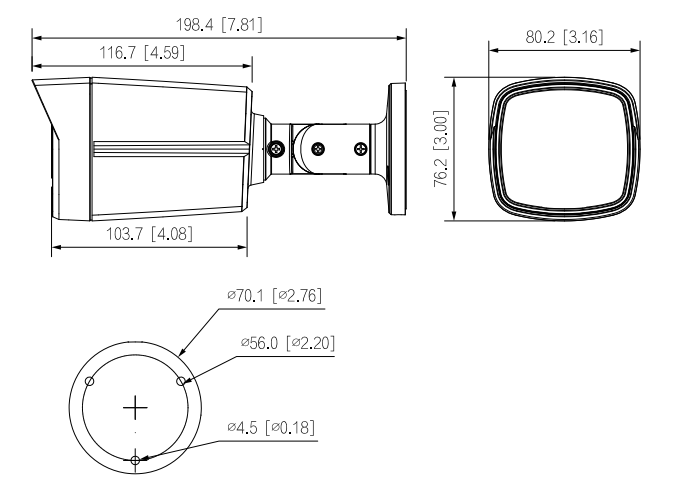





# WD Purple™

## Surveillance Hard Drives

WD Purple™ drives are built for 24/7, always-on, high-definition security systems. With a supported workload rate\* of up to 180 TB/yr and support for up to 64 cameras, WD Purple™ drives are optimized for surveillance systems. WD Purple™ surveillance storage also comes with WD's exclusive AllFrame 4K™ technology, so you can confidently create a security system tailored to the needs of your business. Using AllFrame 4K™ technology, WD Purple™ drives improve ATA streaming to help reduce errors, pixelation, and video interruptions that could happen in a video recorder system.



### INTERFACE

SATA 6 Gb/s

### FORM FACTOR

3.5-inch

### PERFORMANCE CLASS

5400 RPM Class

### CAPACITIES

500GB to 10TB

### MODEL NUMBERS

WD100PURZ	WD30PURX
WD800PURX	WD20PURX
WD60PURX	WD10PURX
WD50PURX	WD05PURX
WD40PURX	

## Product Features

### The right drive for the right job

WD Purple™ drives have been engineered specifically for surveillance, so they're able to withstand the extreme heat fluctuations and equipment vibrations within a NVR environment. An average desktop drive is built to run for only short intervals, not the harsh 24/7 always-on environment of a high-definition surveillance system. A disruption to a drive could result in a failure that impacts multiple users, your security archive, or even the entire system. With WD Purple™, you get reliable, surveillance-class storage that's tested for compatibility in a wide-range of security systems.

### Industry-leading storage. Surveillance you can trust.

WD is a worldwide leader in the hard drive industry. With WD Purple™ surveillance storage, you have a drive engineered for high temperature, always-on surveillance systems so you can rely on quality video playback when you need it most. Whether you're protecting loved ones or monitoring your business, WD Purple™ offers performance you can trust.

### Wide compatibility. Seamless integration.

WD Purple™ hard drives are built with compatibility in mind, so you can quickly and seamlessly add capacity to your surveillance system. With a wide range of industry-leading enclosures and chipsets supported, you're sure to find the DVR configuration that's right for you.\*\*

\*\*Not sure what drive is best for your system? Use our compatibility tool to find the perfect storage for your DVR or NVR.

### Expand your view to 64

Each WD Purple™ drive is optimized to support up to 64 cameras. With so many options, you have the flexibility to upgrade or expand your security system in the future.

### Trust your view with AllFrame 4K™

Missed frames and lost footage could be a serious problem when video surveillance needs to be retrieved. All WD Purple™ drives are equipped with AllFrame 4K™ technology, which improves ATA streaming to help reduce frame loss, improve overall

video playback, and increase the number of hard drive bays supported within a NVR.

#### Features:

- Engineered specifically for surveillance security systems.
- Three times the workload rating of our desktop hard drives\*.
- Tuned for write-intensive, low bit-rate, high stream-count applications typical to most surveillance applications.
- Prioritized write-operations for maximized surveillance performance.
- TLER & ATA streaming support.
- Support for more than eight bays.\*\*\*

\*Workload Rate is defined as the amount of user data transferred to or from the hard drive. Workload Rate is annualized (TB transferred X(8760 / recorded power-on hours)). Workload Rate will vary depending on your hardware and software components and configurations.

\*\*\*For capacities 4TB and higher.

### Less power. More efficient.

Low power consumption is a necessity in a high-temperature, always-on surveillance environment. With our exclusive IntelliSeek™ technology, WD Purple™ drives are able to calculate optimum seek speeds. This keeps power consumption low so ambient noise and vibrations are at a minimum.

### Three year limited-warranty

As an industry-leading hard drive manufacturer, WD stands behind their surveillance storage solutions. With a 3-year limited warranty included with every WD Purple™ drive, you can rely on your surveillance system's data storage capabilities.

## The WD Advantage

At WD, we put our products through extensive Functional Integrity Testing (F.I.T.™) prior to any product launch. This testing ensures our products consistently meet the high quality and reliability standards of the WD brand. WD also has a detailed Knowledge Base with more than 1,000 helpful articles as well as helpful software and utilities. Our customer support lines have long operational hours to ensure you get the help you need when you need it. Our toll-free customer support lines are here to help or you can access our WD Support site for additional details.



Specifications	10TB	8TB	6TB	5TB	4TB	3TB	2TB
Model number <sup>1</sup>	WD100PURZ	WD80PUZX	WD60PURX	WD50PURX	WD40PURX	WD30PURX	WD20PURX
Formatted capacity <sup>2</sup>	10TB	8TB	6TB	5TB	4TB	3TB	2TB
Form factor	3.5-inch	3.5-inch	3.5-inch	3.5-inch	3.5-inch	3.5-inch	3.5-inch
Advanced Format (AF)	Yes	Yes	Yes	Yes	Yes	Yes	Yes
RoHS compliant <sup>3</sup>	Yes	Yes	Yes	Yes	Yes	Yes	Yes
<b>Performance</b>							
Interface transfer rate (max) <sup>2</sup> Buffer to host Host to/from drive (sustained)	6 Gb/s 210 MB/s	6 Gb/s 178 MB/s	6 Gb/s 175 MB/s	6 Gb/s 170 MB/s	6 Gb/s 150 MB/s	6 Gb/s 145 MB/s	6 Gb/s 145 MB/s
Cache (MB) <sup>2</sup>	256	128	64	64	64	64	64
Performance Class	5400 RPM Class	5400 RPM Class	5400 RPM Class	5400 RPM Class	5400 RPM Class	5400 RPM Class	5400 RPM Class
<b>Reliability/Data Integrity</b>							
Load/unload cycles <sup>4</sup>	300,000	300,000	300,000	300,000	300,000	300,000	300,000
Non-recoverable read errors per bits read	<1 in 10 <sup>14</sup>	<1 in 10 <sup>14</sup>	<1 in 10 <sup>14</sup>	<1 in 10 <sup>14</sup>	<1 in 10 <sup>14</sup>	<1 in 10 <sup>14</sup>	<1 in 10 <sup>14</sup>
Limited warranty (years) <sup>5</sup>	3	3	3	3	3	3	3
<b>Power Management</b>							
Average power requirements (W) Read/Write Idle Standby and Sleep	6.2 5.0 0.5	6.4 5.7 0.7	5.3 4.9 0.4	5.3 4.9 0.4	5.1 4.5 0.4	4.4 4.1 0.4	4.4 4.1 0.4
<b>Environmental Specifications<sup>6</sup></b>							
Temperature (°C, on the base casting) Operating Non-operating	0 to 65 -40 to 70	0 to 65 -40 to 70	0 to 65 -40 to 70	0 to 65 -40 to 70	0 to 65 -40 to 70	0 to 65 -40 to 70	0 to 65 -40 to 70
Shock (Gs) Operating (2 ms, read/write) Operating (2 ms, read) Non-operating (2 ms)	30 65 250	30 65 250	30 65 250	30 65 250	30 65 250	30 65 250	30 65 250
Acoustics (dBA) <sup>7</sup> Idle Seek (average)	20 29	20 29	25 26	25 26	25 26	23 24	23 24
<b>Physical Dimensions</b>							
Height (in./mm, max)	1.028/26.1	1.028/26.1	1.028/26.1	1.028/26.1	1.028/26.1	1.028/26.1	1.028/26.1
Length (in./mm, max)	5.787/147	5.787/147	5.787/147	5.787/147	5.787/147	5.787/147	5.787/147
Width (in./mm, ± .01 in.)	4/101.6	4/101.6	4/101.6	4/101.6	4/101.6	4/101.6	4/101.6
Weight (lb/kg, ± 10%)	1.43/0.65	1.43/0.65	1.65/0.75	1.65/0.75	1.50/0.68	1.40/0.64	1.40/0.64

<sup>1</sup> Not all products may be available in all regions of the world.

<sup>2</sup> As used for storage capacity, one megabyte (MB) = one million bytes, one gigabyte (GB) = one billion bytes, and one terabyte (TB) = one trillion bytes. Total accessible capacity varies depending on operating environment. As used for buffer or cache, one megabyte (MB) = 1,048,576 bytes. As used for transfer rate or interface, megabyte per second (MB/s) = one million bytes per second, and gigabit per second (Gb/s) = one billion bits per second. Effective maximum SATA 6 Gb/s transfer rate calculated according to the Serial ATA specification published by the SATA-IO organization as of the date of this specification sheet. Visit [www.sata-io.org](http://www.sata-io.org) for details.

<sup>3</sup> WD hard drive products manufactured and sold worldwide after June 8, 2011, meet or exceed Restriction of Hazardous Substances (RoHS) compliance requirements as mandated by the RoHS Directive 2011/65/EU.

<sup>4</sup> Controlled unload at ambient condition.

<sup>5</sup> See <http://support.wd.com/warranty> for regional specific warranty details.

<sup>6</sup> No non-recoverable errors during operating tests or after non-operating tests.

<sup>7</sup> Sound power level.



# WD Purple™

Specifications	1TB	500GB
Model number <sup>1</sup>	WD10PURX	WD05PURX
Formatted capacity <sup>2</sup>	1TB	500GB
Form factor	3.5-inch	3.5-inch
Advanced Format (AF)	Yes	Yes
RoHS compliant <sup>3</sup>	Yes	Yes
<b>Performance</b>		
Interface transfer rate (max) <sup>2</sup>		
Buffer to host	6 Gb/s	6 Gb/s
Host to/from drive (sustained)	110 MB/s	110 MB/s
Cache (MB) <sup>2</sup>	64	64
Performance Class	5400 RPM Class	5400 RPM Class
<b>Reliability/Data Integrity</b>		
Load/unload cycles <sup>4</sup>	300,000	300,000
Non-recoverable read errors per bits read	<1 in 10 <sup>14</sup>	<1 in 10 <sup>14</sup>
Limited warranty (years) <sup>5</sup>	3	3
<b>Power Management</b>		
Average power requirements (W)		
Read/Write	3.3	3.3
Idle	2.9	2.9
Standby and Sleep	0.4	0.4
<b>Environmental Specifications<sup>6</sup></b>		
Temperature (°C, on the base casting)		
Operating	0 to 65	0 to 65
Non-operating	-40 to 70	-40 to 70
Shock (Gs)		
Operating (2 ms, read/write)	30	30
Operating (2 ms, read)	65	65
Non-operating (2 ms)	350	350
Acoustics (dBA) <sup>7</sup>		
Idle	21	21
Seek (average)	22	22
<b>Physical Dimensions</b>		
Height (in./mm, max)	1.028/26.1	1.028/26.1
Length (in./mm, max)	5.787/147	5.787/147
Width (in./mm, ± .01 in.)	4/101.6	4/101.6
Weight (lb/kg, ± 10%)	0.99/0.45	0.99/0.45

<sup>1</sup> Not all products may be available in all regions of the world.

<sup>2</sup> As used for storage capacity, one megabyte (MB) = one million bytes, one gigabyte (GB) = one billion bytes, and one terabyte (TB) = one trillion bytes. Total accessible capacity varies depending on operating environment. As used for buffer or cache, one megabyte (MB) = 1,048,576 bytes. As used for transfer rate or interface, megabyte per second (MB/s) = one million bytes per second, and gigabit per second (Gb/s) = one billion bits per second. Effective maximum SATA 6 Gb/s transfer rate calculated according to the Serial ATA specification published by the SATA-IO organization as of the date of this specification sheet. Visit [www.sata-io.org](http://www.sata-io.org) for details.

<sup>3</sup> WD hard drive products manufactured and sold worldwide after June 8, 2011, meet or exceed Restriction of Hazardous Substances (RoHS) compliance requirements as mandated by the RoHS Directive 2011/65/EU.

<sup>4</sup> Controlled unload at ambient condition.

<sup>5</sup> See <http://support.wd.com/warranty> for regional specific warranty details.

<sup>6</sup> No non-recoverable errors during operating tests or after non-operating tests.

<sup>7</sup> Sound power level.

Western Digital  
3355 Michelson Drive, Suite 100  
Irvine, California 92612  
U.S.A.

#### For service and literature:

<http://support.wd.com>  
[www.wd.com](http://www.wd.com)

800.ASK.4WDC North America  
(800.275.4932)  
800.832.4778 Spanish  
+86.21.2603.7560 Asia Pacific  
00800.27549338 Europe  
(toll free where available)  
+31.880062100 Europe/Middle East/  
Africa

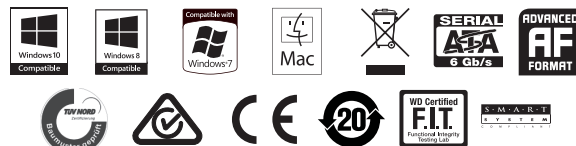

#### CAN ICES-3 (B) / NMB-3 (B)

WD, the WD logo, AllFrame 4K, IntelliSeek, FIT Lab, and WD Purple are registered trademarks or trademarks of Western Digital Corporation or its affiliates in the US and/or other countries. All other marks are the property of their respective owners. Product specifications subject to change without notice. Picture shown may vary from actual product. Not all products are available in all regions of the world.

© 2017 Western Digital Corporation or its affiliates. All rights reserved.

2879-800012-A06 Mar 2017

# DC12V5A-4

Fuente de alimentación conmutada

Salida DC 12 V 5 A

4 salidas por terminales +/-

Protección por fusible 2A

164 (Fo) x 37 (Al) x 55 (An) mm

280 g



Fuente de Alimentación Conmutada (Transformador)

Salida DC 12 V / 5 A

4 salidas por terminales +/-

Protección por fusible 2A

Cable a enchufe incluido

Permite alimentar de 1 hasta 4 dispositivos simultáneamente

# Specifications

Entrada de alimentación	AC 90/264 V
Salida de alimentación	DC 12 V 5 A
Número de salidas	4 por terminales +/-
Dimensiones	164 (Fo) x 37 (Al) x 55 (An) mm
Peso	280 g