

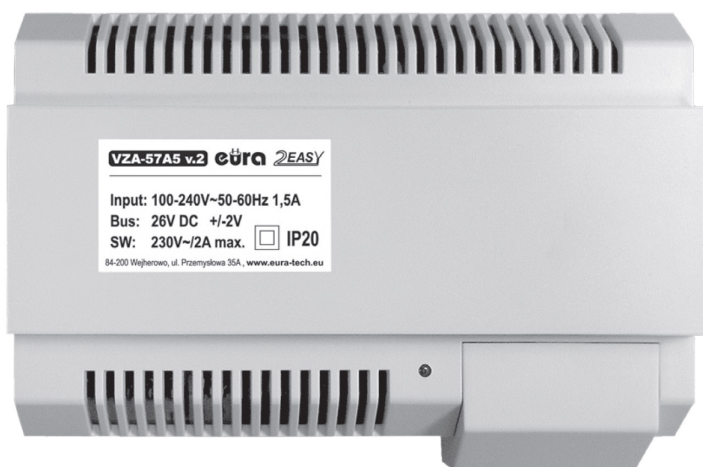

POWER SUPPLY FOR DIN RAIL

VZA-57A5 v. 2



User Manual

INITIAL REMARKS

Before assembling, wiring and setting up of device the user should carefully read given manual. In case of any troubles with understanding the content the user should contact the producer. Unassisted assembling and start of the device can be done only with the use of proper tools. However, it is highly advised to set up a device by qualified personnel. The producer is not responsible for damages made during incorrect set-up or maintenance or in case of any unassisted repairs or modifications.

TABLE OF CONTENTS

1. DEVICE CHARACTERISTICS.....	3
2. DEVICE CONSTRUCTION.....	4
3. INSTALLATION.....	5
4. WIRING DIAGRAM	6
5. TECHNICAL DATA	6

1. DEVICE CHARACTERISTICS

The VZA-57A5 is a power comb unit, which is designed for 2-wire Eura 2 Easy system to supply power for outdoor video doorphone, indoor monitor and other accessories. It can work both as a normal power comb and auxiliary power comb (replacing VZA-53A5 and VXA-45A5). The features are:

- Universal AC input/full range.
- Multi protection: short circuit, overload, over voltage.
- Integrated with power separator (the power separator isn't needed).
- Support up to 4 monitors (depend on models).
- DIN rail mounting.

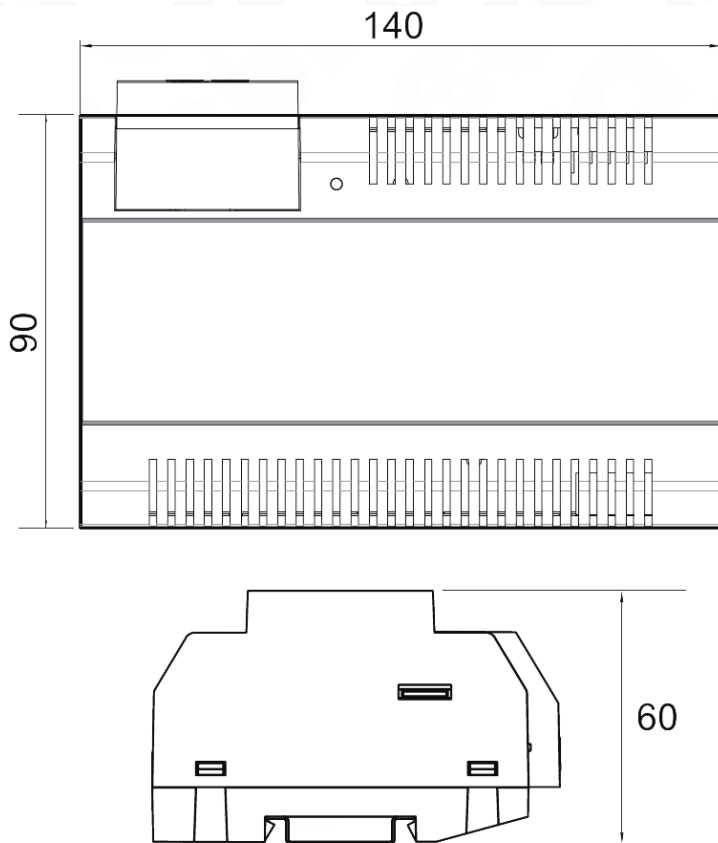

Fig. 1. Dimensions

WARNING!

1. The unit can only be used in 2-wire Eura 2 Easy products supplied by our company.
2. Don't connect the unit with any non-specified power source. Fire or electric shock could result. Don't dismantle or alter the unit. Fire or electric shock could result.
3. The unit must be installed and wired by a qualified technician.

2. DEVICE CONSTRUCTION

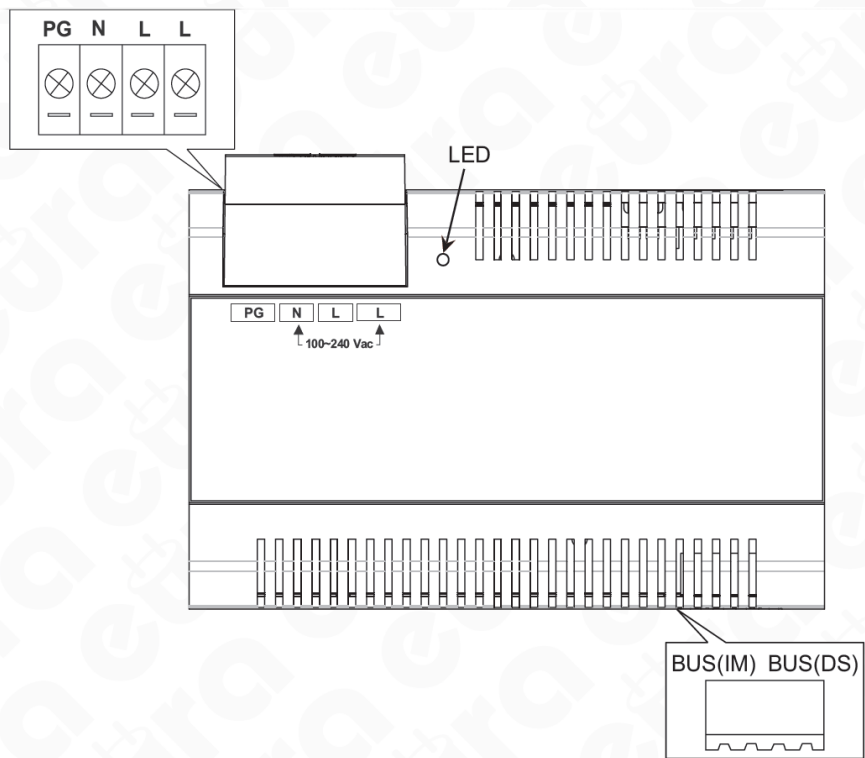

Fig. 2. Construction of VZA-57A5

Element	Symbol	Purpose
Terminal	N	AC input
	L	AC input
	PG	Earth ground port
Diode	LED	Power indicator, always on when plugged in
BUS	BUS (IM)	Indoor monitor connection terminal
	BUS (DS)	outdoor unit connection terminal

3. INSTALLATION

Fig. 3 show installation of VZA-57A5 on DIN Rail (this power supply can be mounted on the wall too).

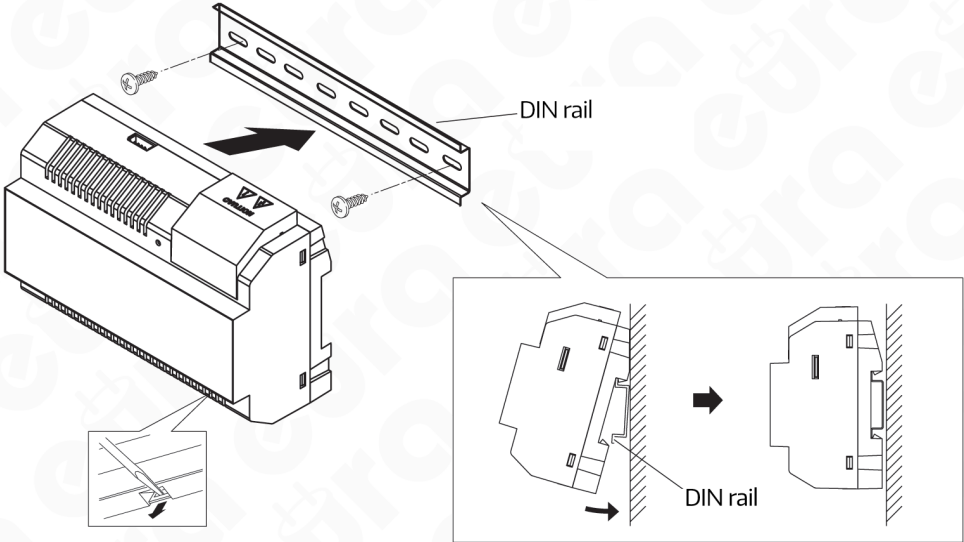

Fig. 3. VZA-57A5 installation

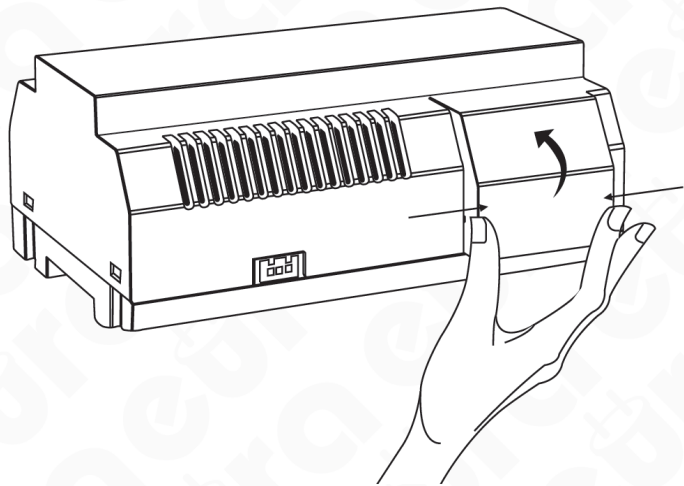

Fig. 4

4. WIRING DIAGRAM

To connect wire correctly, open the AC cover (fig. 4):

- 1. push the cover bottom towards the center with your hand;
- 2. turn over and pull it out.

After connect the AC cable, it is suggested to close the cover. The wiring diagram is presented on fig. 5.

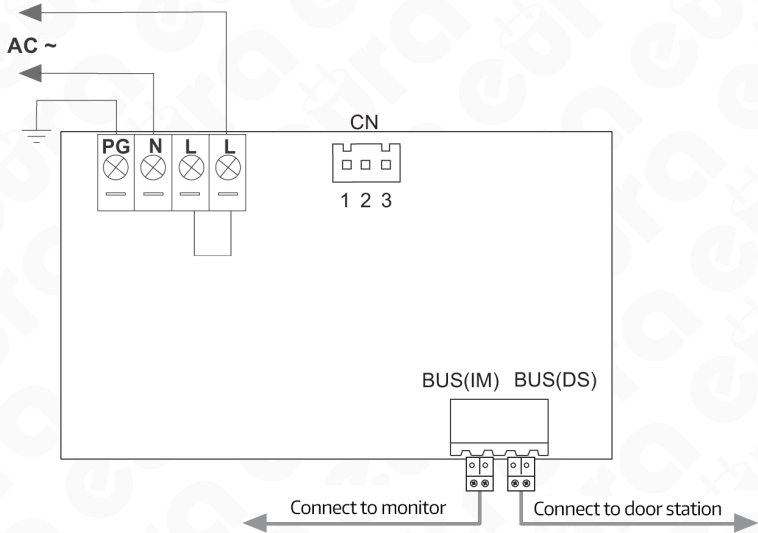

Fig. 5. Wiring diagram

5. TECHNICAL DATA

Input Voltage	100-240V AC
Input Frequency	50-60 Hz
Rated Output Current	1.5A
Rated Output Voltage	DV 26V ± 2V
SW and N Ports Rated Input Current	2A
SW and N Ports Input Voltage	230V AC
Waterproof rating	IP20
Working Temperature	-10°C...+50°C
Dimensions (H x W x D)	90 x 140 x 60 (mm)
Weight	531g

EU Conformity Declaration of this device is available on
<http://www.eura-tech.eu> website



Eura-Tech Sp. z o.o.

ul. Przemysłowa 35A, 84-200 Wejherowo, POLAND
www.eura-tech.eu

All rights reserved.

Pictures, graphs and texts are the property of "Eura-Tech" Sp. z o.o.
Copying, distributing and publication without permission of author is forbidden.