

IP Camera

Quick Start Guide



Statement

- Thank you for using our products, please read this manual carefully before use.
- This manual is applicable to network series products.
- This manual may contain technical inaccuracies that do not correspond to the functions and operation of the product or typographical errors. The contents of this manual will be updated as product features are enhanced, and updates will be added to *new versions* of this manual without notice.
- If there are some differences between the description of the product in the manual and the actual product, the actual product shall always prevail.

Safety Precautions

- Please avoid installing the product in a vibration or shock environment and keep the product away from electromagnetic interference (ignoring this may damage the product).
- In order to avoid heat accumulation, please keep good ventilation around the device, and do not block the vent of the device.
- Do not install indoor products in an environment that may be exposed to water or other liquids.
- Do not use the product in extremely hot, cold, dusty, or high humidity environments.
- Please store the device in a dry, non-corrosive environment and out of direct sunlight.

Installation

Remind:

- Fix the expansion plugs to the wall first and then lock the screw if it is a concrete wall. Install it directly with screws if it is a wooden wall.
- The installation of all control, display, recording and other terminal equipment of the camera should be smooth and easy to operate.
- All cables in the control room shall be provided with cable troughs and inlet holes according to the installation location of the equipment. They shall be arranged, bundled neatly, numbered, and permanently marked.
- The pictures in this manual are for reference only, please make the object as the standard.

Small Bullet Series

- 1 Fix the bracket to the wall with screws.

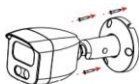

- 2 By rotating the round joint and bracket to achieve the longitudinal and axial adjustment of the camera.



- 3 Tighten the screws with hex wrench to complete the installation.



Big Bullet Series

If you have an external card slot, loosen the two screws first, remove the card cover, insert the memory card, and finally lock the card cover.

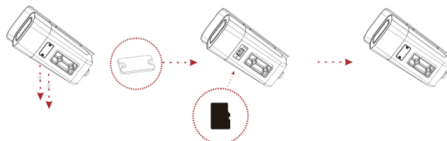

Rear Mounting Bracket Installation

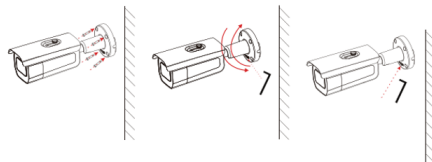

- 1 Fix the bracket to the wall with screws.
- 2 Loosen the screws with hex wrench to adjust the viewing angle.
- 3 Tighten the screws with hex wrench to complete the installation.

Bottom mounting bracket

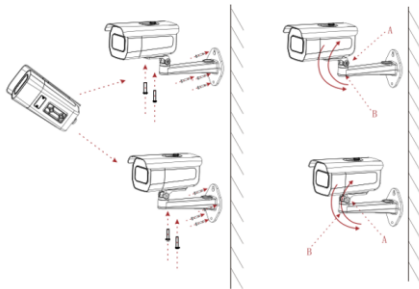

- 1 Fix the camera to the bracket with screws. The bracket head can be pre-mounted or post-mounted, and then fixed to the wall with screws.
- 2 Loosen the screws at A/B, adjust the viewing angle, tighten the screws to complete the installation.

Conch Series I

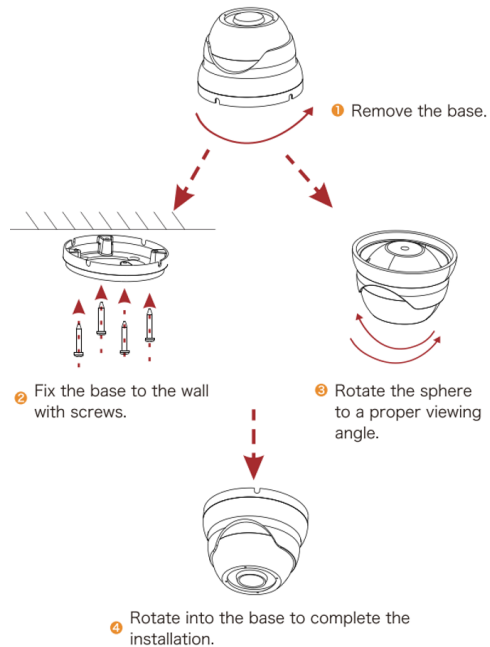

Conch Series II

- ❶ Unscrew the screws and remove the base.

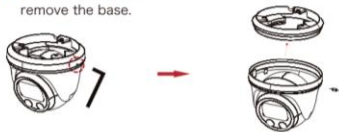

- ❷ Fix the base to the wall with screws.

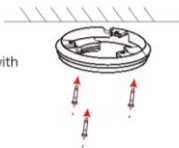

- ❸ Rotate the sphere to the proper viewing angle, snap the groove of the base, and tighten the screws on the side to complete the installation.

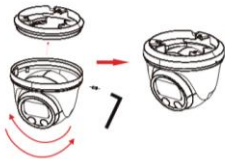

Conch Series III

- ❶ Rotate until the two triangle indicating signs overlap to remove the base.

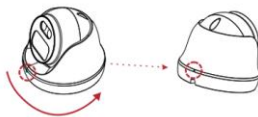

- ❷ Fix the base to the wall with screws.

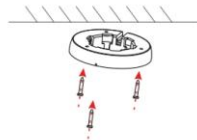

- ❸ Snap the sphere into the base.



- ❹ Adjust the angle: rotate the sphere to a proper viewing angle to complete installation.



Conch Series IV



- ① Rotate and then remove the decorative ring upward.

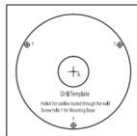

- ② Attach the stickers on the wall in the appropriate position.



- ③ Break off the wire outlet hole on the base with dental plier and fix the wire harness to the wire outlet hole.

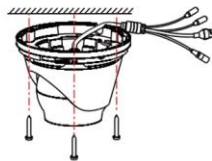

- ④ Fix the camera to the wall with screws.

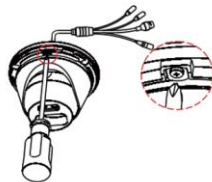

- ⑤ Rotate the sphere to a proper viewing angle and tighten the screws.

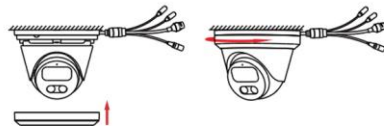

- ⑥ Put the decorative ring upward and rotate it tightly to complete the installation.

Small Dome Series

Fast Mounting Bracket Installation

- ❶ Fix the fast mounting bracket to the wall with screws.

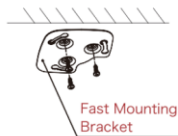

- ❷ Adjust the viewing angle by rotating the sphere and then hang the camera into the quick mount bracket by rotating the body.

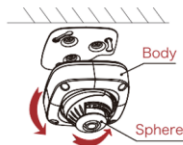

- ❸ Complete the installation.



Chassis Installation

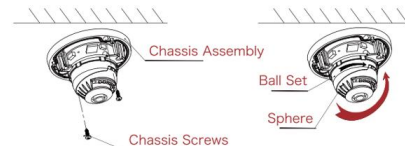

- ❶ Fix the chassis assembly to the wall with screws.

- ❷ Adjust the viewing angle by rotating the sphere. For certain models, it is necessary to organize the wiring independently before closing the cover to avoid affecting the appearance and functionality.

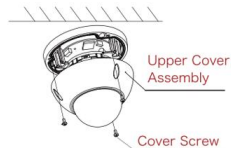

- ❸ Lock the upper cover assembly to the chassis assembly with 3 screws.

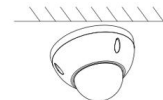

- ❹ Installation is complete.

Big Dome Series

Top loading

The factory default is the best angle, if you need to adjust:



- ① Loosen 4 screws and remove the cover.



- ② Rotate the movement horizontally and vertically to adjust the angle.

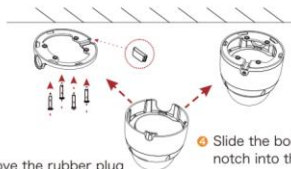

- ③ Remove the rubber plug and fix the base with 4 screws.

- ④ Slide the body into the notch into the base.

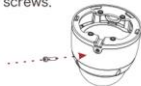

- ⑤ Screw in, fix the sphere to complete the installation.

Big Dome Series

Wall mounting

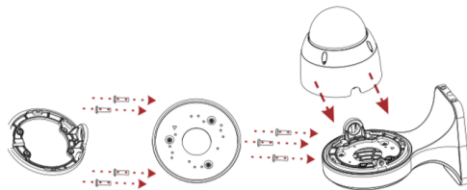

- ① Fix the base and bracket mounting plate to the bracket body with screws.

- ② Snap the camera body into the base.

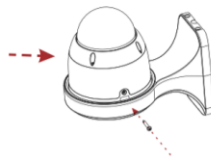

- ③ Fix the camera with screw and complete the installation.

- ④ Remove the iron plate from the bracket and fix the iron plate to the wall with 4 screws.

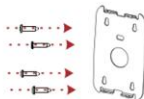

- ⑤ Remove the wire hole plug, put the body bracket equipped with the camera into the iron plate, and fix with 4 screws.



Micro Camera Series

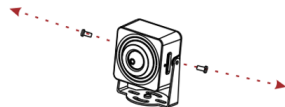

- ① Loosen 2 screws to separate the bracket from the camera body.

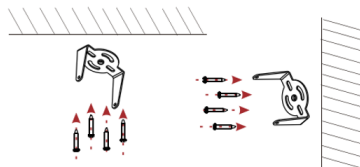

- ② Use 4 screws to fix the bracket to the ceiling or fix it to the side wall.

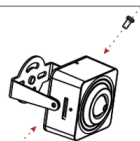

- ③ Use two screws to fix the camera body and the bracket together. Please do not tighten. Please screw on after adjusting the viewing angle.

Get Started

1. Network Setting

The default IP address of all cameras is 192.168.1.168. The IPv4 address of the computer must be in the same network segment as the IP address of the IP camera. To enable the camera to access the network smoothly, plan the available IP network segments based on the actual network environment.

Prepare the network

(1) Add the same network segment IP as 192.168.1.168 (camera factory default IP) in the computer, such as 192.168.1.165.

Steps to add an IP address to the Windows system:

Step 1: Click [Start] → [Control Panel] → [Network and Sharing Center] → [Local Network] → [Properties] → [Internet Protocol Version 4 (TCP/IPv4)] → [Advanced] to enter the advanced TCP/IP setting interface.

Step 2: Click [Add] in the IP address (R) position, enter the IP address as 192.168.1.165 and the subnet mask 255.255.255.0, and click [Add] → [OK] → [OK] → [OK].

(2) Connect camera and PC by network cable in the same LAN, power on. Connecting as following (schematic diagram of the switch, device, and PC connected together).



The network configuration steps are as

Step 1: Open [Search Tool]. Download from: <https://www.visiotechsecurity.com/es/productos/cctv-ip/camaras-ip-profesionales/easy-ip>

Step 2: Check 192.168.1.168.

Step 3: Modify the IP and other related network parameters on the right side of the interface

Step 4: Enter the user name (default is admin) and password (default is 123456) of the device.

Step 5: Click [Modify] → [Confirm].



Step 6: Click [Refresh] to search for the modified IP address and the network configuration is successful.

NOTE: When configuring network parameters, ensure that the IPC address and the computer's IPv4 address are on the same network segment.

2. Modify password

Step 1: Open the IE browser, enter the IP address of IP Camera (if the IP has not been modified, please enter the default address <http://192.168.1.168>), and press [Enter].

Step 2: Enter the username (default is admin) and password (default is 123456) of the device and click [Login].

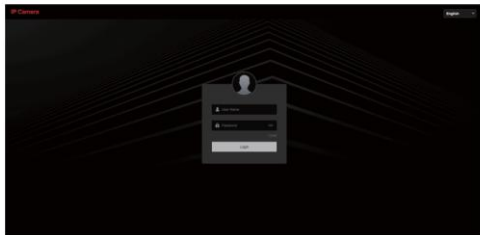

Step 3: Click [Modify], enter the password, confirm the password, set the security question, click [Export Key] → and click [OK].

A screenshot of the 'Edit Users' configuration page. The form includes fields for 'Old Password', 'User Name' (set to 'admin'), 'User Type' (set to 'Admin'), 'Password', and 'Confirm Password'. Below these is a note about password requirements: 'The length of the password is 8 to 31 digits, and only two or more combinations of numbers, lowercase letters, uppercase letters, and special characters (~!@#\$%^&*~_+{}|;':",./?) can be used'. There is a checked checkbox for 'Do you want to set a new security question'. This is followed by three security questions, each with a dropdown menu and an answer field. At the bottom are 'Export Key' and 'OK' buttons.

3. Real-time preview and parameter configuration

Step 1: Click [Please download the browser plugin here, please close the browser when the download is complete], download the plug-in, close the browser, and follow the prompts to install the plug-in.

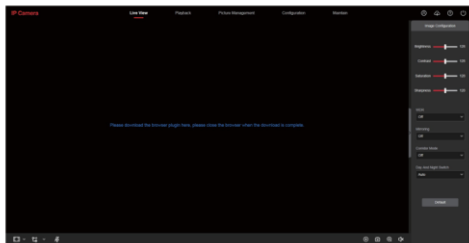

Step 2: Open the browser and log in to the IPC WEB interface again to preview the real-time video.

NOTE: If you are using a browser other than IE, you can directly enter the preview video interface without installing a plug-in.



Step 3: Click [Configuration] can enter the device configuration interface, there are local configuration, system, local network, video, image, event and other functional configurations. Users can set these functions according to the actual situation of the application scenario to achieve the best monitoring effect.

