



User Manual

Digital AM/FM Tuner

CE-F308R

NAMES AND THEIR FUNCTIONS

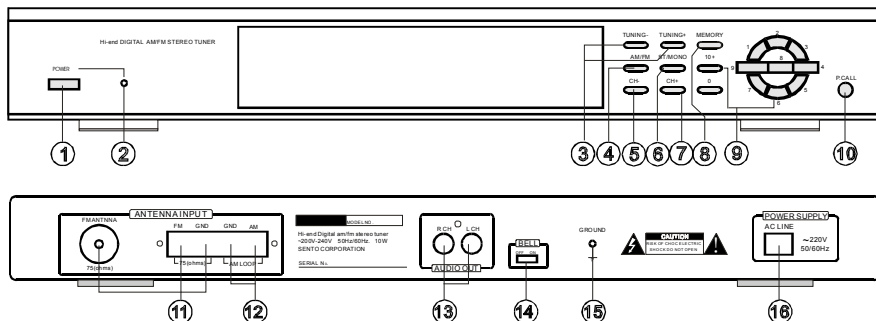

1. Power switch

Press this switch to turn on and off unit's power.

2. Power indicator

This indicator lights when unit's power is turned on.

3. Tuning up/down select key

Press this to increase and decrease the tuning frequency.

4. AM/FM band select key

Press this to select between AM/FM band.

5. CH- select key

6. Stereo/mono select key

7. CH+ select key

8. Memory

Press this button and press the desired memory location in storing the desired station to memory.

9. Channel button keys (0-10)

10. Frequency input playing key

11. FM antenna input terminal

12. AM antenna input terminal

13. Audio output

Audio signal of the tuner.

14. Bell switch

15. GROUND

16. AC 220V Power cord

CONNECTING TO THE STEREO AMPLIFIER

Connect the output terminal of the unit to the stereo amplifier's TUNER terminal by an RCA plug cord.

AM/FM ANTENNA CONNECTION

Connect the wire of the accessory AM loop antenna terminal and 75Ω antenna to the FM ANT terminal.

Note: Always keep the power cord away from the antenna.

BASIC OPERATION

1. Depress the POWER switch to turn on the unit's power.
2. Select the desired broadcast band using the BAND selector button either on the front panel or remote control.
3. To tune automatically, press the UP and DOWN key and it will automatically search for a strong signal then stop, to search for another station repeat this procedure.

PRESETTING STATIONS TO MEMORY

By storing desired broadcast stations in advance, you can easily recall a broadcast station by designating the corresponding preset memory channel.

1. Follow the basic operating procedure to tune-in to the desired broadcast station to be preset to the memory.
2. Press the MEMORY button, then press the desired memory location and the number selected will appear on the screen.
3. By repeating the above procedure, you can preset a combined total of 60 stations.

NAMES AND REMOTE FUNCTIONS

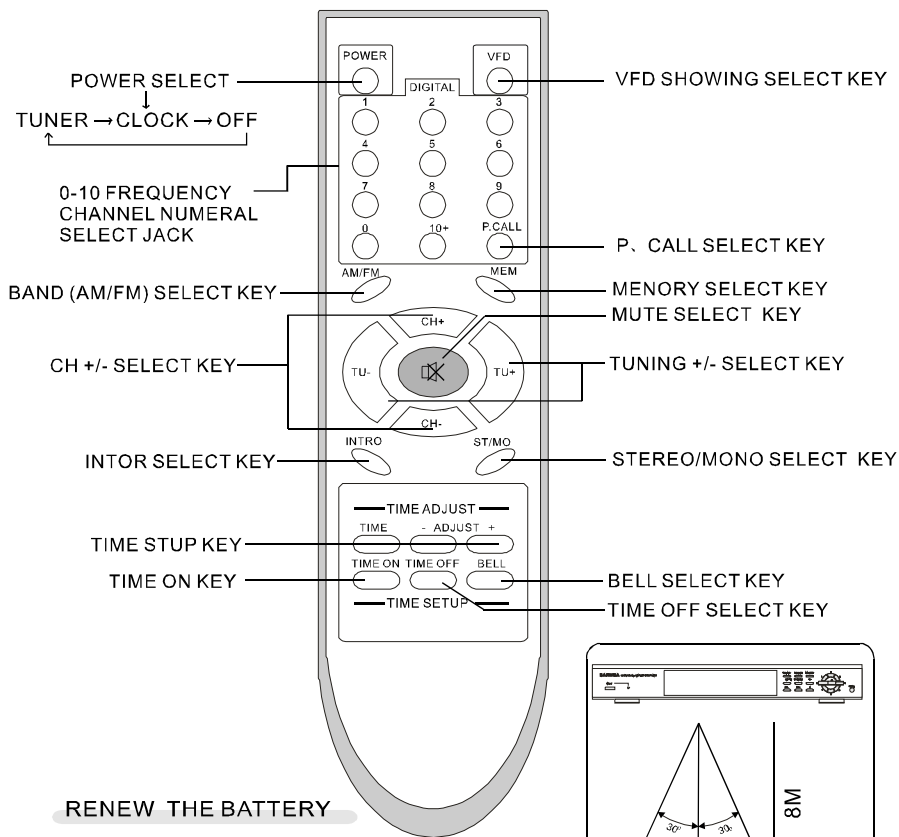

RENEW THE BATTERY

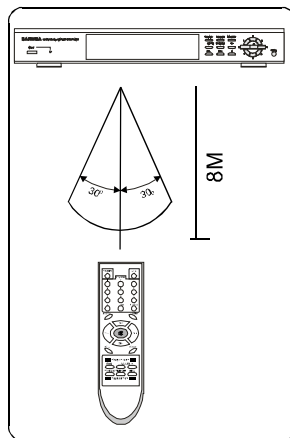
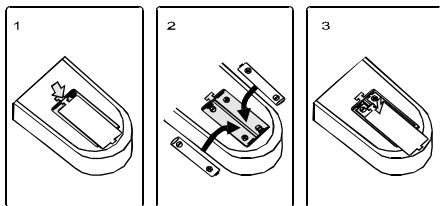

AMSECTION:

Frequency range.....522-1620 KHz STEPS 9KHz
Sensitivity.....≥16dB
S/N.....≥40dB
Distortion.....≤0.3%
Frequency Response.....80Hz-4KHz

OTHERS

Audio output.....500mVrms
Output impedance.....1KΩ
Input voltage.....AC 220V 60Hz
Power consumption....6 Watts
Memory.....60 Station

FMSECTION:

Frequency range.....87.5-108MHz STEPS 50KHz
Sensitivity.....≥20dB
S/N.....≥40dB
Distortion.....≤0.2%
Frequency Response.....20Hz-20KHz
Antenna Impedance.....75Ω



CAUTION:Do not open the equipment cover arbitrarily,
so as not to electric shock.Please contact the professionals
to maintain if necessary .

CEOPA corporation
www.ceopa.com